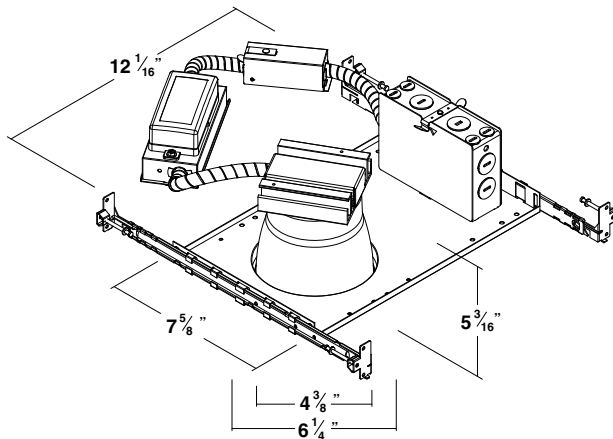

PROJECT NAME: _____ CATALOG NUMBER: _____

NOTES: _____ FIXTURE SCHEDULE: _____

Page: 1 of 2

**LED 4" COMMERCIAL RECESSED
DOWNLIGHT FIXTURE****RCF SERIES****PRODUCT DESCRIPTION:**

These NON-IC commercial recessed downlight fixtures are an economical LED lighting solution for new construction applications including offices, healthcare facilities, educational institutions and other buildings that want to reduce maintenance and energy consumption without sacrificing quality of light.

FEATURES:

- Unique optic allows high lumen transmission while concealing the LED light source resulting in efficient, inviting light and minimizing LED glare
- Junction box listed for through branch circuit wiring (Max. 8 no.12AWG 90C conductors, 4 in and 4 out)
- Suitable for damp location use
- Dimmable down to 5% (120v only)
- Five year warranty

ELECTRICAL:

- Universal voltage, driver can be supplied with 120V-277V
- LED array will provide minimum 50,000 hour L70 lifetime

MODEL SELECTION (Full list of order codes on pg. 2)

Typical order example: RCF42630W

SR4-RCF	4			W
FAMILY	SIZE	WATTAGE (NOMINAL)	CCT	TRIM COLOR
RCF= Commercial Recessed Frame	4= 4" Nominal diameter reflector	15= 15W 26= 26W	3K= 3000K 4K= 4000K	W= White

ACCESSORIES

ORDER CODE	MODEL NUMBER	DESCRIPTION	ACCESSORIES IMAGE
74086	RR4-BNRING	4" Brushed Nickel Trim Ring	

LED 4" COMMERCIAL RECESSED DOWNLIGHT FIXTURE

RCF SERIES

Page: 2 of 2

SPECIFICATIONS:

		RCF41530W	RCF41540W	RCF42630W	RCF42640W
ITEM	SPECIFICATION	15 WATTS - DETAILS		26 WATTS - DETAILS	
GENERAL PERFORMANCE	Color Temperature	3000K	4000K	3000K	4000K
	Lumens Delivered (lm)	785	875	1340	1515
	Efficacy (lm/w)	56	63	52	58
	Lumen Maintenance (L70)	50,000 hours		50,000 hours	
ELECTRICAL	Power Consumption	14 Watts		26 Watts	
	Power Factor	>0.9		>0.9	
	Input Voltage	120V-277V		120V-277V	
PHYSICAL	Mounting	Adjustable (24" max) bar hangers with nails for installation to joists or standard grid ceilings		Adjustable (24" max) bar hangers with nails for installation to joists or standard grid ceilings	
	Operating Temperature	-4 F to 113 F		-4 F to 113 F	
APPLICATION	Environment	Dry, Damp		Dry, Damp	
	Insulation	Non-IC, insulation must be kept 3" from all sides of the housing		Non-IC, insulation must be kept 3" from all sides of the housing	
	Warranty	5 Year		5 Year	

Lighting layouts and spacing criteria available upon request

ORDERING:

ORDER CODE	MODEL	OPTIONS	OUTPUT (LUMENS)	CCT
72910	RCF4	None	---	---
73677	RCF41530W	15W LED 4" COMMERCIAL RECESSED DOWNLIGHT FIXTURE 3000K	785	3000K
73678	RCF41540W	15W LED 4" COMMERCIAL RECESSED DOWNLIGHT FIXTURE 4000K	875	4000K
73434	RCF42630W	26W LED 4" COMMERCIAL RECESSED DOWNLIGHT FIXTURE 3000K	1340	3000K
73436	RCF42640W	26W LED 4" COMMERCIAL RECESSED DOWNLIGHT FIXTURE 4000K	1515	4000K

COMPATIBLE DIMMERS:

MAKE	DIMMER MODEL
Lutron	CTCL-153PD*
Lutron	DVCL-153PL*
Lutron	CTELV-303P
Lutron	DVELV-303P
Lutron	LGCL-153PL*
Leviton	IPI10 Leviton

* Dimming control should be adjusted to 5% minimum light output level in order to avoid flickering. Please consult dimming control instruction manual for specific procedure.