

PROJECT NAME: \_\_\_\_\_ CATALOG NUMBER: \_\_\_\_\_

NOTES: \_\_\_\_\_ FIXTURE SCHEDULE: \_\_\_\_\_

Page: 1 of 2

**LED 6" COMMERCIAL RECESSED  
DOWNLIGHT FIXTURE**

RCF Series

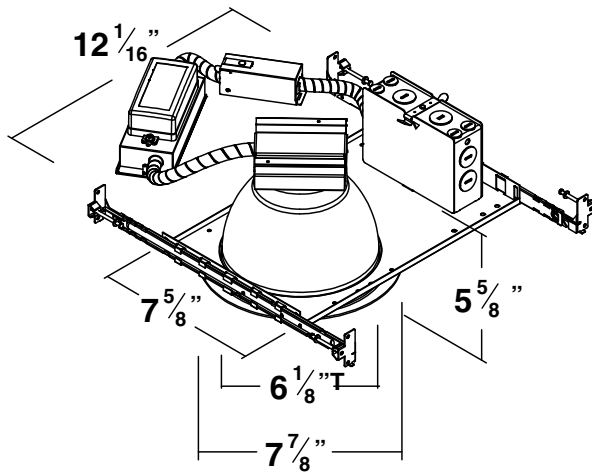
**PRODUCT DESCRIPTION:**

These NON-IC commercial recessed downlight fixtures are an economical LED lighting solution for new construction applications including offices, healthcare facilities, educational institutions and other buildings that want to reduce maintenance and energy consumption without sacrificing quality of light.

**FEATURES:**

- Unique optic allows high lumen transmission while concealing the LED light source resulting in efficient, inviting light and minimizing LED glare
- Junction box listed for through branch circuit wiring (Max. 8 no.12AWG 90C conductors, 4 in and 4 out)
- Suitable for damp location use
- Dimmable down to 5% (120v only)
- Five year warranty

**ELECTRICAL:**

- Universal voltage, driver can be supplied with 120V-277V
- LED array will provide minimum 50,000 hour L70 lifetime

**MODEL SELECTION** (Full list of order codes on pg. 2)

Typical order example: RCF63430W

SR6-RCF	6			W
FAMILY	SIZE	WATTAGE (NOMINAL)	CCT	TRIM COLOR
RCF= Recessed Commercial Frame	6= 6" Nominal diameter reflector	15= 15W 26= 26W 34= 34W	30= 3000K 40= 4000K	W= White

**ACCESSORIES**

ORDER CODE	MODEL NUMBER	DESCRIPTION	ACCESSORIES IMAGE
74087	RR6-BNRING	6" Brushed Nickel Trim Ring	

# LED 6" COMMERCIAL RECESSED DOWNLIGHT FIXTURE

RCF SERIES

Page: 2 of 2

## SPECIFICATIONS:

		RCF61530W	RCF61540W	RCF62630W	RCF62640W	RCF63430W	RCF63440W
ITEM	SPECIFICATION	15 WATTS - DETAILS		26 WATTS - DETAILS		34 WATTS - DETAILS	
GENERAL PERFORMANCE	Color Temperature	3000K	4000K	3000K	4000K	3000K	4000K
	Lumens Delivered (lm)	825	910	1400	1575	1995	2140
	Efficacy (lm/w)	59	65	54	61	59	63
	Lumen Maintenance (L70)	50,000 hours		50,000 hours		50,000 hours	
ELECTRICAL	Power Consumption	14 Watts		26 Watts		34 Watts	
	Power Factor	>0.9		>0.9		>0.9	
	Input Voltage	120V-277V		120V-277V		120V-277V	
PHYSICAL	Mounting	Adjustable (24" max) bar hangers with nails for installation to joists or standard grid ceilings		Adjustable (24" max) bar hangers with nails for installation to joists or standard grid ceilings		Adjustable (24" max) bar hangers with nails for installation to joists or standard grid ceilings	
	Operating Temperature	-4 F to 113 F		-4 F to 113 F		-4 F to 113 F	
APPLICATION	Environment	Dry, Damp		Dry, Damp		Dry, Damp	
	Insulation	Non-IC, insulation must be kept 3" from all sides of the housing		Non-IC, insulation must be kept 3" from all sides of the housing		Non-IC, insulation must be kept 3" from all sides of the housing	
	Warranty	5 Year		5 Year		5 Year	

Lighting layouts and spacing criteria available upon request

## ORDERING:\*

ORDER CODE	MODEL	OPTIONS	OUTPUT (LUMENS)	CCT
72912	RCF6	6" COMMERCIAL RECESSED FRAME	---	---
73681	RCF61530W	15W LED 6" COMMERCIAL RECESSED DOWNLIGHT FIXTURE 3000K	825	3000K
73682	RCF61540W	15W LED 6" COMMERCIAL RECESSED DOWNLIGHT FIXTURE 4000K	910	4000K
73438	RCF62630W	26W LED 6" COMMERCIAL RECESSED DOWNLIGHT FIXTURE 3000K	1400	3000K
73440	RCF62640W	26W LED 6" COMMERCIAL RECESSED DOWNLIGHT FIXTURE 4000K	1575	4000K
73442	RCF63430W	34W LED 6" COMMERCIAL RECESSED DOWNLIGHT FIXTURE 3000K	1995	3000K
73444	RCF63440W	34W LED 6" COMMERCIAL RECESSED DOWNLIGHT FIXTURE 4000K	2140	4000K

## COMPATIBLE DIMMERS:

MAKE	DIMMER MODEL
Lutron	CTCL-153PD*
Lutron	DVCL-153PL*
Lutron	CTELV-303P
Lutron	DVELV-303P
Lutron	LGCL-153PL*
Leviton	IPI10 Leviton

\* Dimming control should be adjusted to 5% minimum light output level in order to avoid flickering. Please consult dimming control instruction manual for specific procedure.